

# Owner's Manual



[www.bestirongatemotor.com](http://www.bestirongatemotor.com)

9949 Hayward Way, South El Monte, CA 91733

# 1.Packing List

- A. Camera & transformer
- B. Bracket
- C. Antenna
- D. Screw Kit
- E. Operating Manual
- F. Waterproof Case

# 2.Camera Installation

- A. Tighten Antenna clockwise



- B. Plug transformer into electric outlet

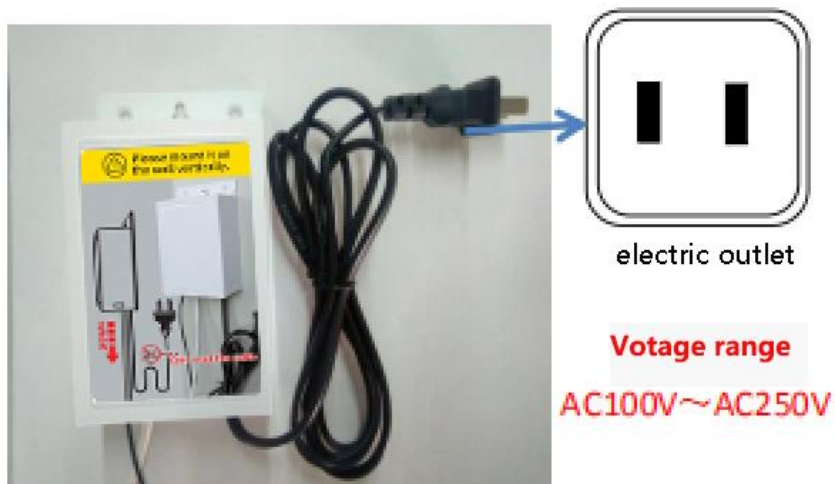

- C. Light is solid red when transformer is plugged into electric outlet

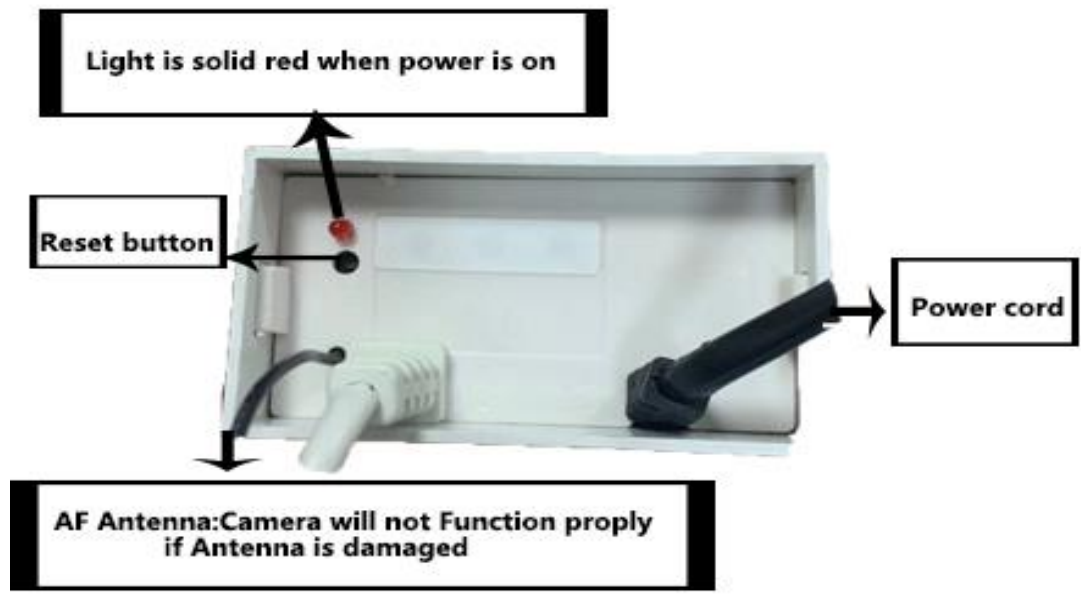

### 3. Connect Camera to Internet

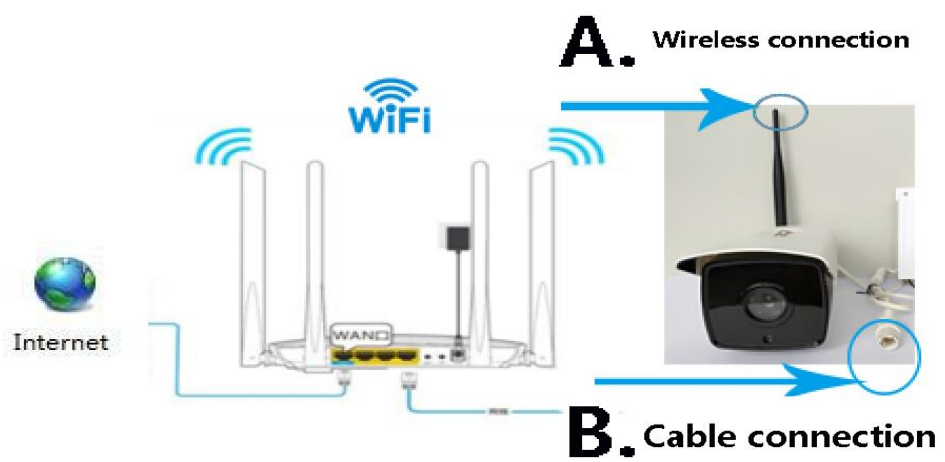

A. Wireless Connection

B. Cable Connection( light stays solid green after connection is successful)

# App Download

IOS vs Android

1. Smartgate / Search smartgate on Apple Store
2. Smartgate / Search smartgate on Google Play

Smartgate Icon appears when download is successful



# App Registration

1. Registered / Click register on the main page
2. Enter email or phone number and password then click "get verification code"
3. Enter verification code that is sent to the email address or phone number that is registered
4. Click registered to complete the registration process

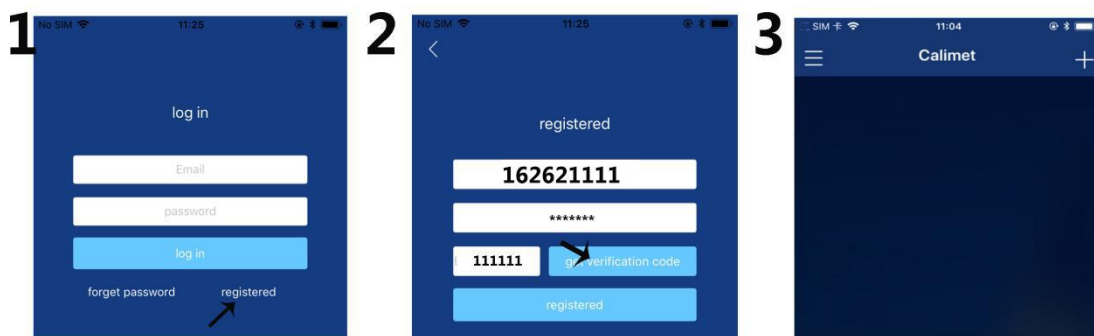
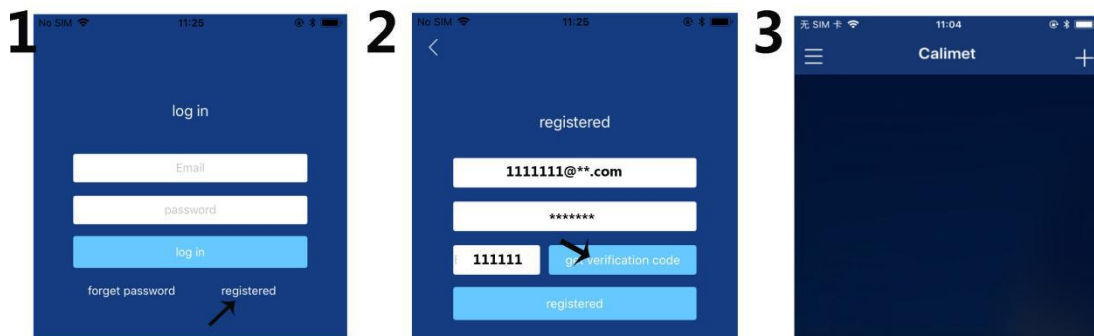

# Connecting phone to camera

## A. connecting to WIFI

1. Open smartgate APP, enter email or phone number and password
2. Plug transformer to electrical outlet, press reset button located on the back side of transformer for 8 seconds
3. Click Setting on your phone, then turn on Wi-Fi, search and click the signal that starts with "SmartDoor"
4. Go to Smartgate APP, click plus button on the right upper corner
5. Search starts automatically, camera CID number will appear shortly
6. Create camera name, or "My Device" by default
7. Enter WIFI name and password then press enter

Video Screen appears (to prevent mismatch, do not click video screen when it is connecting)

"connected" appears when complete, check live video to ensure correct camera is linked

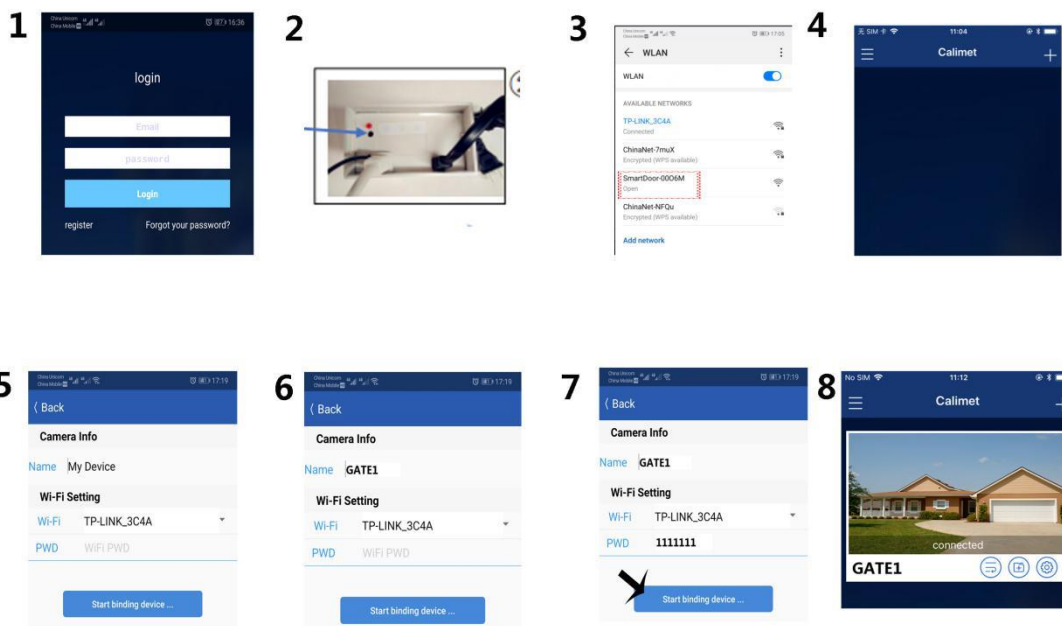





Follow WIFI sync procedure for cable network (green light stays solid when cable is successfully connected to the device)

## **To sync camera and receiver**

1. Press learning button on cm control or cm receiver, make sure the light is solid red
2. Sign in the smartgate APP, click on the camera
3. Press open button, until gate is moving
4. Connection is complete (Note: receiver's frequency is 418mhz)

## **APP Description**

**Control Panel**

 Add Gate	 180° Rotation
 Delete Gate	 Go to control Panel
 Screen Shot	 N/A
 Video Recording	 N/A

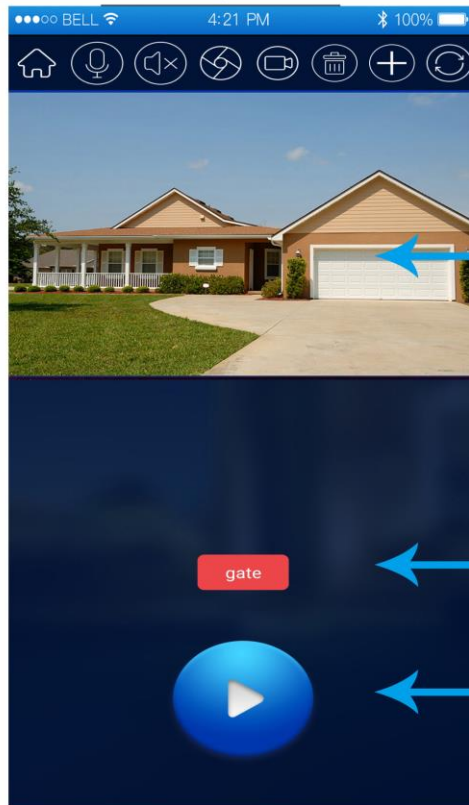

Live video  
(do not open/close gate When camera is not set correctly)

Switch Gate

OPEN/CLOSE BUTTON

1. One Camera can remotely control up to eight gates
2. Camera can be used as control console (418MHz)
3. Single: use "Add Gate" to link one gate
4. Multiple: use "Add Gate" to link one gate
5. Add up to eight gates



## App Operation

Add friends and share cameras

1. Click Menu on the upper left corner, then press "My Circle".



2. Press “Add” on upper right corner, enter friend’s registration account.
3. Friend’s account appears when complete.
4. Go back to control panel to choose the camera that you would like to share, then click setting.
5. Check the account that is designated to share, blue check mark means account is successfully added.
6. Account that is being added can open/close gate and view live video, but is not authorized to share video to others.
7. Click the blue check button to disable the sharing option.

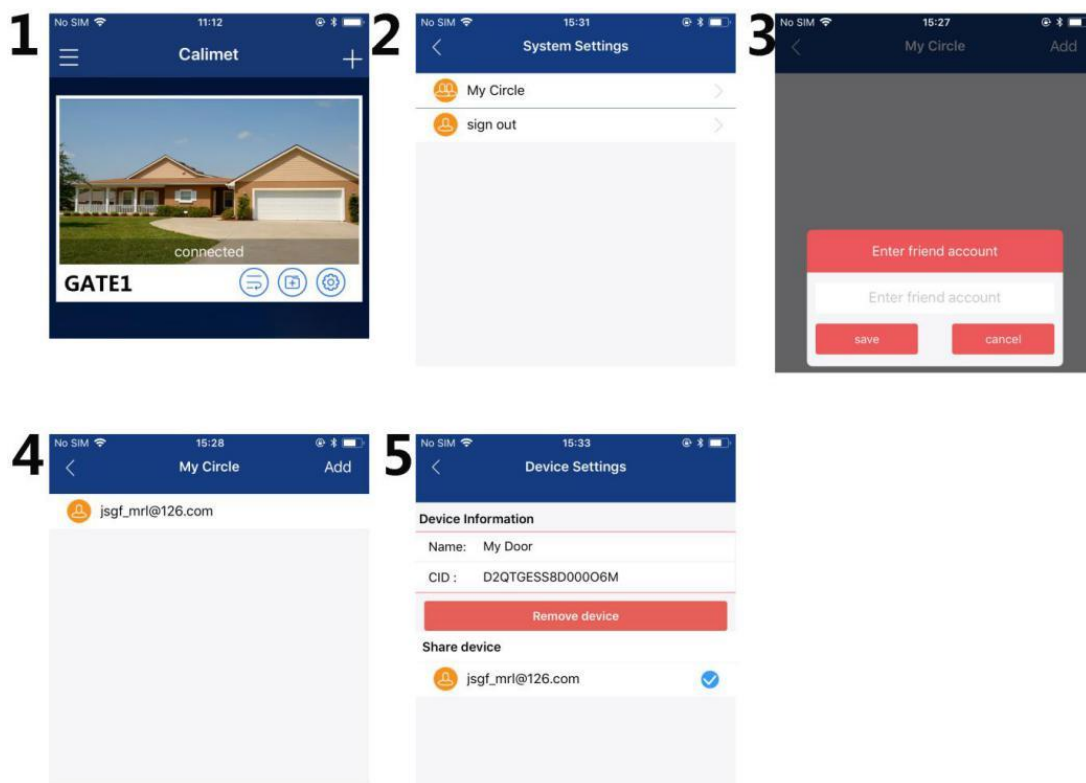

#### Video Rewind

1. Go to Control Panel
2. Click Rewind Button
3. Select time frame, the selected button becomes blue

4. Press Start button (delay may occur based on internet speed)



5. The camera is equipped with 16g memory card as, which can be upgraded to 64g upon request.

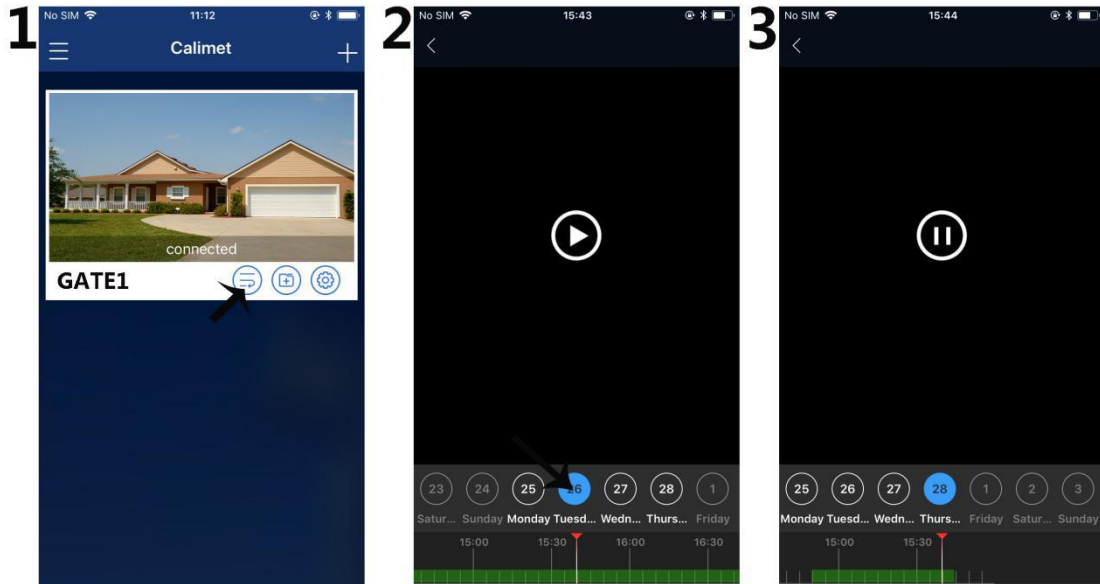

#### Delete Camera

1. Go to Control Panel
2. Click Setting

### 3. Delete the Camera

